

Tidewater Woodworkers Guild



Notes from the Wood House

Greetings all! I hope everyone has not been driven out of their shop due the heat.

Earlier this summer, Chad Larson, Gary Scott and I had the opportunity to help Andy Westrich cut some large logs into lumber. We cut black walnut, poplar, cherry and red oak.

Once finished, we loaded the wood and took the freshly cut wood and stacked it in my shop. With all this heat, my shop acted as a kiln and the wood is about ready to be worked. Anyone looking for some quarter sawn red oak?

Last month, Jack Spillane provided us with a great presentation on tool sharpening. I know we were all so impressed that a few guild members contacted the glass company that Jack recommended and made many calls to the suggested glass supplier for

the plate glass. The owner was a bit overwhelmed. He has asked not to be contacted for anymore "free" glass. I am working on an alternative source for the glass. Please note that there will be a charge for the glass.

Earlier this month, we were treated to a great presentation by the folks from DeWalt/Delta. The folks from Delta were impressed by our turnout of 42 guild members and guests. We even had a contingency from Williamsburg (3 folks from the Ford's Colony Woodworkers). Had the heat had not been so intense, I am sure we would have an even larger turnout.

Many thanks to those who brave the heat to attend. We are still working with Delta for some sort of promotion specifically for Guild members. And, Delta has already expressed an interest to be a

presenter for one of our meetings early next year.

Wood Chips

I have been informed by Pat Taylor that the TWWWG shirts that members ordered should be available at the August meeting. For those of you that ordered a S-XL size shirt, the cost of the shirt will be \$18.00. For anyone that ordered an XXL shirt or larger, the cost will be \$20.00. Pat will accept cash or a check made payable to Pat Taylor. If you have any questions, please contact Pat or myself.

Despite all efforts, we are not back in our house. I was hoping to report that we would be back in the house by the August gathering. Progress has picked up dramatically and we hope to be home by the second weekend of September.

August 2006

Next Meeting

September 28, 2006
7:00PM

Woodcraft of Norfolk
5802 E. Virginia Beach Blvd.
Norfolk, VA 23502
(757) 466-1166

Monthly Meeting

4th Monday of Each
Month

Find Us On the Web

www.twwwg.com

Please note that parts of the site are password protected. The password is provided to those whose dues are current.

Club Dues

Dues are \$15.00 per year and are payable by check or cash.

Upcoming Meetings

Bret Lancaster will be coordinating presenters and demonstrators each month. If you know of someone that would be a good presenter or if you would like to demonstrate your talents, please contact Bret.

August

Guest Presenter
Gene George
Finger Joinery

September

Guest Presenter
Douglas Gordon
Furniture Making

The Executive Board

Andy Steinberg	President/Editor	624-9151
Bret Lancaster	Vice President	631-0634
Bill Hoffman	Secretary	420-7087
Gene George	Treasurer	499-7281
Pat Taylor	Past President	481-3167

Tips and Techniques for the Workshop

This month, we are providing a revised article from *Woodsmith Magazine*. The original article was submitted by Pat Taylor.

Pipe Clamp Storage

Many of us have accumulated quite a collection of pipe clamps, but have never found a convenient way to store them. Utilizing some left over PVC plumbing pipe, one can create a snap-in pipe clamp storage system.

The trick discovered is that if you cut a section of 1" pipe lengthwise, a little off center, the 3/4" pipe of the clamp will snap securely into it. Thus, the clamp rack is simply a series of pipe sections screwed to a piece of plywood, as shown in Fig. 2.

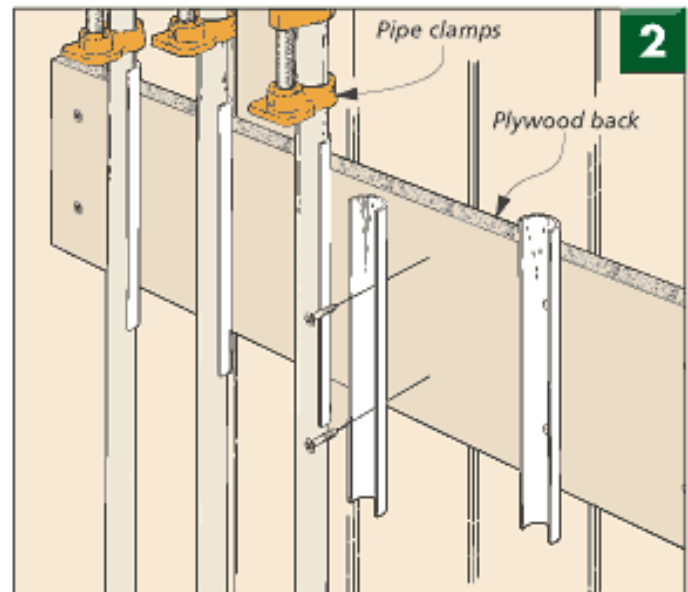
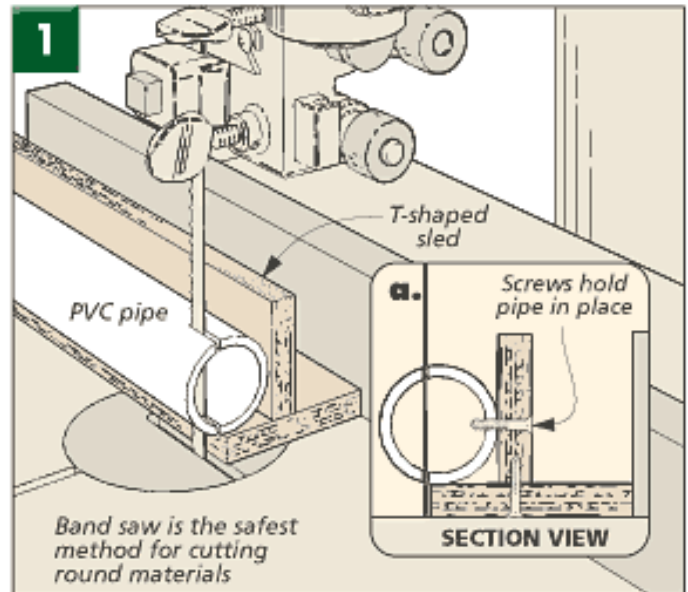

Figure 1

The only hurdle to cross is making the lengthwise cuts on the sections of PVC pipe safely. Fig. 1 shows how to do this. By utilizing a piece of plywood to create a sled to hold the pipe sections in place, the PVC can be run through band saw to make the cuts. A pair of screws holds the pipe sections to the sled and the same screw holes can later be used to attach the pipe sections to the rack.

To get the right fit in the holders, create a test section of PVC pipe to set the band saw fence. The clamps should snap easily into place but with enough "grab" to hold them firmly.

Once installed, any clamps that clutter the corner of your shop or table now can be hung on the wall. Shop.



Program Highlights from our July Meeting



In July, Jack Spillane demonstrated the technique of sharpening a chisel using plate glass and stepped grades of sandpaper. Included in his presentation was list of materials, places to purchase the materials and, in general, what works for his woodworking shop.



Here, Jack shows the best way to polish and then put an edge on a chisel. During his technique, Jack showed that creating the mirror finish on the back was part of the process.



No, Jack is not about to hit a front row heckler. He is demonstrating how he applies the stepped sandpaper sheets to the plate glass.

Part of Jack's presentation discussed other commercial sharpening solutions on the market. From what we saw, no one solution seemed to create a better edge than utilizing the glass and sandpaper system.



Jack answers questions from the field. Even Fred Olds could not stump Jack's "sharp" techniques.



Wood'n You Like To Know

Each month we will feature some general information about a wood that you saw in the stores or heard about in conversation but maybe you never took the time to inquire about the wood. If there is a wood you wish to see featured, please contact me and let me know.

Butternut (*Juglans cinerea*), sometimes known as the White Walnut, is a species of walnut native to the eastern United States and southeast Canada, from southern Quebec west to Minnesota, south to northern Alabama and southwest to northern Arkansas. It is a deciduous tree growing to 60 -70 ft. Although the butternut is a close relative of the black walnut, the heartwood is light tan with pinkish or amber tones, sometimes with darker brown streaks; the narrow sapwood is white.

Due to an introduced canker disease butternut has become seriously threatened. In some areas, 80% of the Butternut trees have been killed due to this disease. Completely free-standing trees seem better able to withstand the fungus than those growing in dense stands or forest. The fungus is spread by a wide-ranging vector, so isolation of a tree offers no protection.

Although butternut does not have all the qualities of black walnut, the grain lines are similar. Butternut has coarser texture. The wood polishes well, however, initial sanding will create a fuzzy surface until a fine grit sanding abrasive is utilized.

The wood is used for light-duty furniture and paneling. Some antiques and period reproductions from the Midwest incorporate butternut wood. Butternut is not recommended for environments where the items that may be subjected to heavy use.



Show and Tell



Adrian Marshall shows off his table creation for the 2" X 4" contest. Bob Malloy and Adrian Marshall were the winners of last month's contest. Each winner received a gift certificate to Woodcraft.



Club Discounts Available

Over the years, certain businesses have offered a variety of discounts to our membership. Listed below is a current list of companies that offer some type of discount for products and services.

- Sure Set Saw 13% Discount
- Chesapeake (757) 420-7991
- Cabinet Makers Hardware
- Virginia Beach (757) 490-1185
- Plywood & Plastics
- Norfolk (757) 858-3908
- Scroll-it Service
- Portsmouth (757) 237-6867
- Sherwin Williams Paint 15% Discount
- All stores in Hampton Roads

WOOD SHOP TOOL MANUFACTURERS

Contest:

This puzzle compliments of Ed Bunker, is provided to test your knowledge of Wood Tool Manufacturers.

The top 5 submissions finding the most manufacturers will win prizes.

Answers will be published in next month's newsletters. The winners will be announced at next month's meeting.

Editor's Note:

We have decided to discontinue the monthly publication of the regional craft shows due to lack of response.

If anyone would like a copy of the craft show list, please contact Andy Steinberg or Deb Glaze for a copy.

We apologize for any inconvenience this may have caused.

S	G	C	R	A	F	T	S	M	A	N	M	E	T	E	J	D
R	E	L	A	T	E	L	L	D	R	E	M	E	L	L	N	R
E	R	A	T	L	L	O	W	A	L	I	F	K	S	B	A	I
Y	K	Y	Y	E	L	O	B	I	W	R	E	U	R	A	M	L
E	A	L	A	D	I	T	K	O	E	E	N	A	Y	C	R	L
M	T	A	W	I	H	S	L	U	S	T	D	W	O	R	E	D
E	A	R	E	K	C	E	D	&	K	C	A	L	B	E	H	O
S	N	E	N	D	A	F	L	E	I	G	H	I	I	T	T	C
E	A	N	O	I	T	S	A	T	I	K	A	M	B	R	A	T
I	R	E	G	G	I	B	R	O	T	O	Z	I	P	O	E	O
B	E	G	O	D	H	C	N	E	B	L	U	E	R	P	L	R
A	M	O	C	I	T	A	M	R	E	W	O	P	E	W	I	N
N	O	K	I	R	R	P	A	N	A	S	O	N	I	C	I	T
U	X	A	M	R	O	F	R	E	P	S	W	O	O	D	A	N
G	N	E	O	N	A	S	T	A	R	R	E	T	T	V	E	T
A	A	W	Y	E	S	S	E	B	O	S	H	O	P	V	A	C
L	I	E	N	I	E	L	S	E	N	Y	E	L	N	A	T	S